

Nova 2.0 — Our Next-Generation Glucose Meters - Part 3

The Point of Care (POC) Team introduced **Nova 2.0**, the newest generation of glucose meters coming to all areas beginning in March.

WHAT'S NEW?

- **Seamless transition:** Minimal operational changes - screens and workflows will look familiar.
- **Greatly improved scanner:** Faster, more accurate scanning for a smoother workflow.
- **Enhanced functionality:**
 - **Built-in Wi-Fi** for improved connectivity.
 - **Integrated battery** — no more battery replacements needed.
 - **Side-button reset** to quickly troubleshoot or reboot the meter.

WHAT'S DIFFERENT?

Difference #1 - Different order of sample type options

Overview: The order and layout of the patient screen selection (arterial, capillary, venous) differ from the previous devices.

Meter Appearance: Legacy display order is: Capillary, Venous, Arterial / NEW Nova 2.0 display order is: Arterial, Capillary, Venous

Resource: [TIPS-3](#) – shared on March 19, 2026



Difference #2 – Urine Pregnancy Manual Entry Change

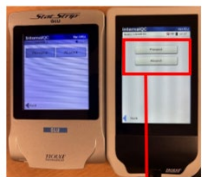

ILL

Overview: The Nova 2.0 meter urine pregnancy manual entry screen differs from the legacy meters.

Meter Appearance: Legacy meters displayed options side-by-side (left/right). Nova 2.0 displays options stacked (up/down).

Action Needed: Control line verification (manual entry): Verify the control line is present and select Present on the meter. If Absent is selected, the test is invalid and the result will not be posted to the patient chart. Follow-up action is needed.

NEW - Difference #3 - Temperature

Overview: New Nova meters feel warmer than the old version. If the meters are not seated properly in the dock or they are really drained, the meter will feel hot as it is charging all the way back up.

Action Needed: Let it sit on the counter to cool down (15-30 minutes). If the meter isn't functioning properly after 30 minutes, or gives the "Temperature Error", bring it to the Point of Care Office (354 Doan).

NEW - Difference #4 – Deep Sleep Mode

Overview: to preserve battery life when the meter is off the docking station. After a few minutes off the dock, the meter enters “deep sleep” and can be woken by pressing the side button, docking, or inserting a strip. The side button can also be used to reboot the meter for troubleshooting - press and hold ~15 seconds.

FOR QUESTIONS OR CONCERNS:

The POC Team is here to support you during the transition.

📞 614- 685-6610

✉ path.glucose@osumc.edu

RESOURCES:

SharePoint Site: [Point of Care Testing Page](#)

